



City of Hoonah

P.O. Box 360 Hoonah, AK 99829 (907) 945-3663 Fax (907) 945-3445

****PUBLIC NOTICE****

Special Council Meeting

Thursday May 25, 2023 @ 6:00 p.m.

The ZOOM call-in number is 1-253-215-8782. The Meeting ID is 833 3100 2711 and
Passcode is 211225

- I. Call to Order**
- II. Roll Call**
- III. Legal Updates from City Attorney**
- IV. Additional Paving Work**
- V. Council/Community Comments- 3-minute time limit**
- VI. Adjourn**

Posted 5-22-23.

City of Hoonah
Additional Paving Costs 5-15-23

White Alice Road - COH Public Works Additional Paving

Item No.	Pay Item Description	Pay Unit	Approximate Quantity	Unit Price		Amount	
				Dollars	Cents	Dollars	Cents
2202.1W	Excavation	CY	211	\$ 29	40	\$ 6,159	
2204.1W	Base Course, Grading D-1	Ton	276	\$ 93	98	\$ 25,766	
2801.1W	2.5" A.C. Pavement	Ton	51	\$ 366	44	\$ 18,710	
2801.1W	3" A.C. Pavement	Ton	98	\$ 366	44	\$ 35,912	

Estimated Construction Subtotal = \$ 86,547

Second Street - Additional Paving

Item No.	Pay Item Description	Pay Unit	Approximate Quantity	Unit Price		Amount	
				Dollars	Cents	Dollars	Cents
2202.1W	Excavation	CY	14	\$ 29	40	\$ 446	
2204.1W	Base Course, Grading D-1	Ton	20	\$ 93	98	\$ 1,958	
2801.1W	2.5" A.C. Pavement	Ton	10	\$ 380	0	\$ 3,800	
	Existing Asphalt Pavement Removal	SY	60	\$ 21	0	\$ 1,260	

Estimated Construction Subtotal = \$ 7,464

Hill Street - Additional Paving

Item No.	Pay Item Description	Pay Unit	Approximate Quantity	Unit Price		Amount	
				Dollars	Cents	Dollars	Cents
2202.1W	Excavation	CY	26	\$ 29	40	\$ 794	
2204.1W	Base Course, Grading D-1	Ton	36	\$ 93	98	\$ 3,446	
2801.1W	2.5" A.C. Pavement	Ton	17	\$ 380	0	\$ 6,460	
	Existing Asphalt Pavement Removal	SY	109	\$ 21	0	\$ 2,289	

Estimated Construction Subtotal = \$ 12,989

Grant Street - Additional Paving

Item No.	Pay Item Description	Pay Unit	Approximate Quantity	Unit Price		Amount	
				Dollars	Cents	Dollars	Cents
2202.1W	Excavation	CY	41	\$ 31	50	\$ 1,321	
2204.1W	Base Course, Grading D-1	Ton	56	\$ 93	98	\$ 5,306	
2801.1W	A.C. Pavement	Ton	27	\$ 492	45	\$ 13,329	
	Existing Asphalt Pavement Removal	SY	172	\$ 31	50	\$ 5,382	

Estimated Construction Subtotal = \$ 25,338

Estimated Construction Total for Additional Paving = \$132,338

IF THIS BAR DOES NOT MEASURE EXACTLY ONE INCH, THE SCALE OF THIS DRAWING HAS BEEN ALTERED DURING ITS PRODUCTION, AFFECTING ALL LABELED SCALES

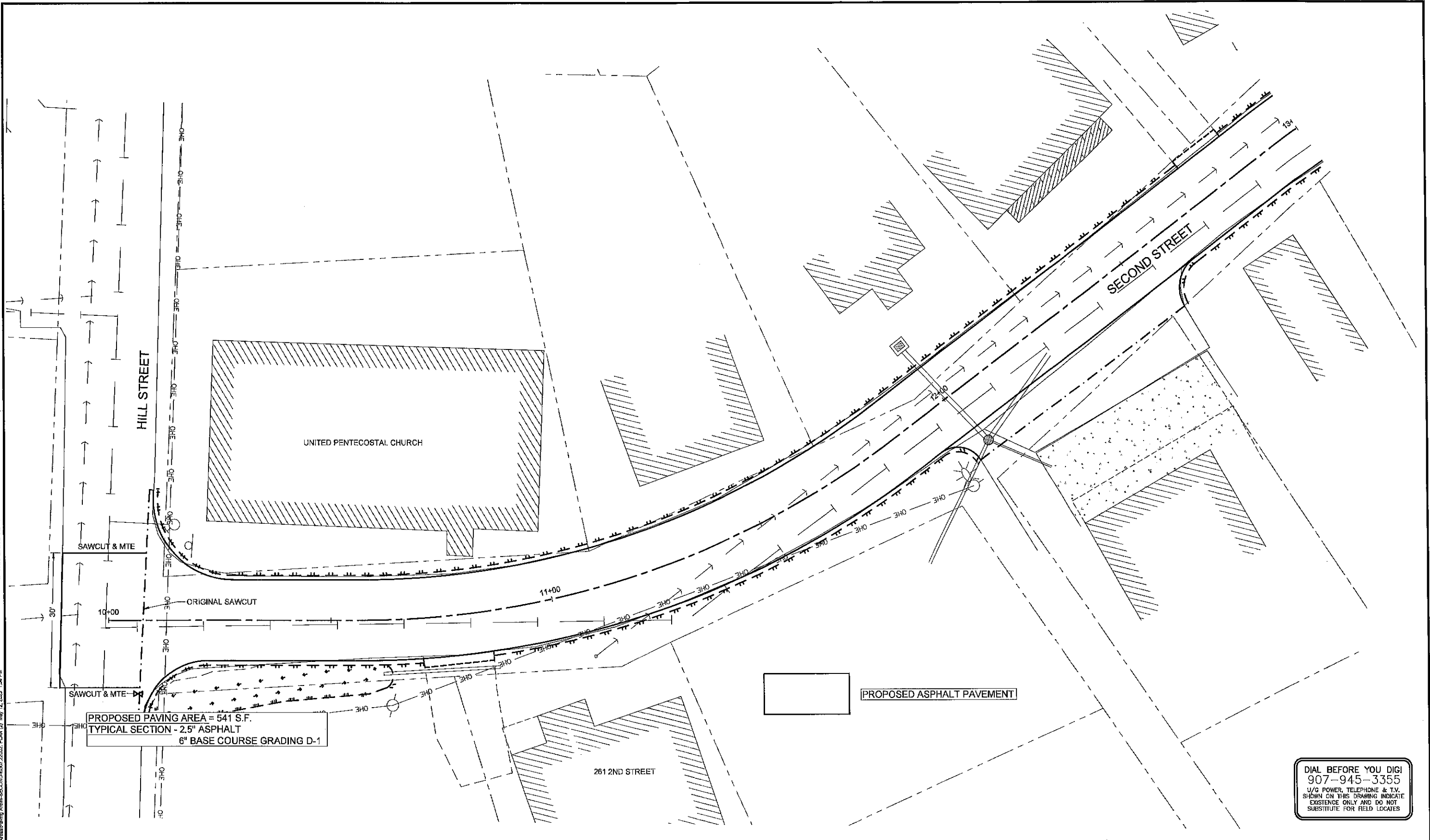

PROPOSED PAVING AREA = 541 S.F.
 TYPICAL SECTION - 2.5" ASPHALT
 6" BASE COURSE GRADING D-1

PROPOSED ASPHALT PAVEMENT

DIAL BEFORE YOU DIG!
 907-945-3355
 U/G POWER, TELEPHONE & T.V.
 SHOWN ON THIS DRAWING INDICATE
 EXISTENCE ONLY AND DO NOT
 SUBSTITUTE FOR FIELD LOCATES

No.	Date	Item
REVISIONS		

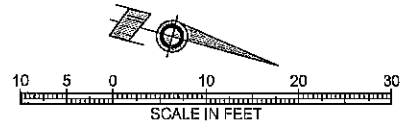

SHEET TITLE:
SECOND STREET PAVING ADDITIONS
 CONSTRUCTION DOCUMENTS

PROJECT:
**CITY OF HOONAH FEMA FLOOD REPAIRS
 DECEMBER 2020 STORM EVENT 4585DR-AK**
 HOONAH, ALASKA

RESPEC
 Juneau, AK
 9109 Marlandell Mall Rd. Ste. 4
 Juneau, AK 99801
 Phone: 907.760.6060
 Fax: 907.586.3771
 AECC163270

STATE OF ALASKA
 49th
 JOSEPH M. POSICH
 10/17/2022
 CE 6152
 REGISTERED PROFESSIONAL ENGINEER

CONSULTANT:

DESIGN	MSM
DRAWN	JMK
CHECKED	JMK
DATE	05/12/2023
PROJECT No.	10307.22002
SHEET NUMBER	

DIAL BEFORE YOU DIG!
 907-945-3355
 U/G POWER, TELEPHONE & T.V.
 SHOWN ON THIS DRAWING INDICATE
 EXISTENCE ONLY AND DO NOT
 SUBSTITUTE FOR FIELD LOCATES

IF THIS BAR DOES NOT MEASURE EXACTLY ONE INCH, THE SCALE OF THIS DRAWING HAS BEEN ALTERED DURING ITS PRODUCTION, AFFECTING ALL LABELED SCALES

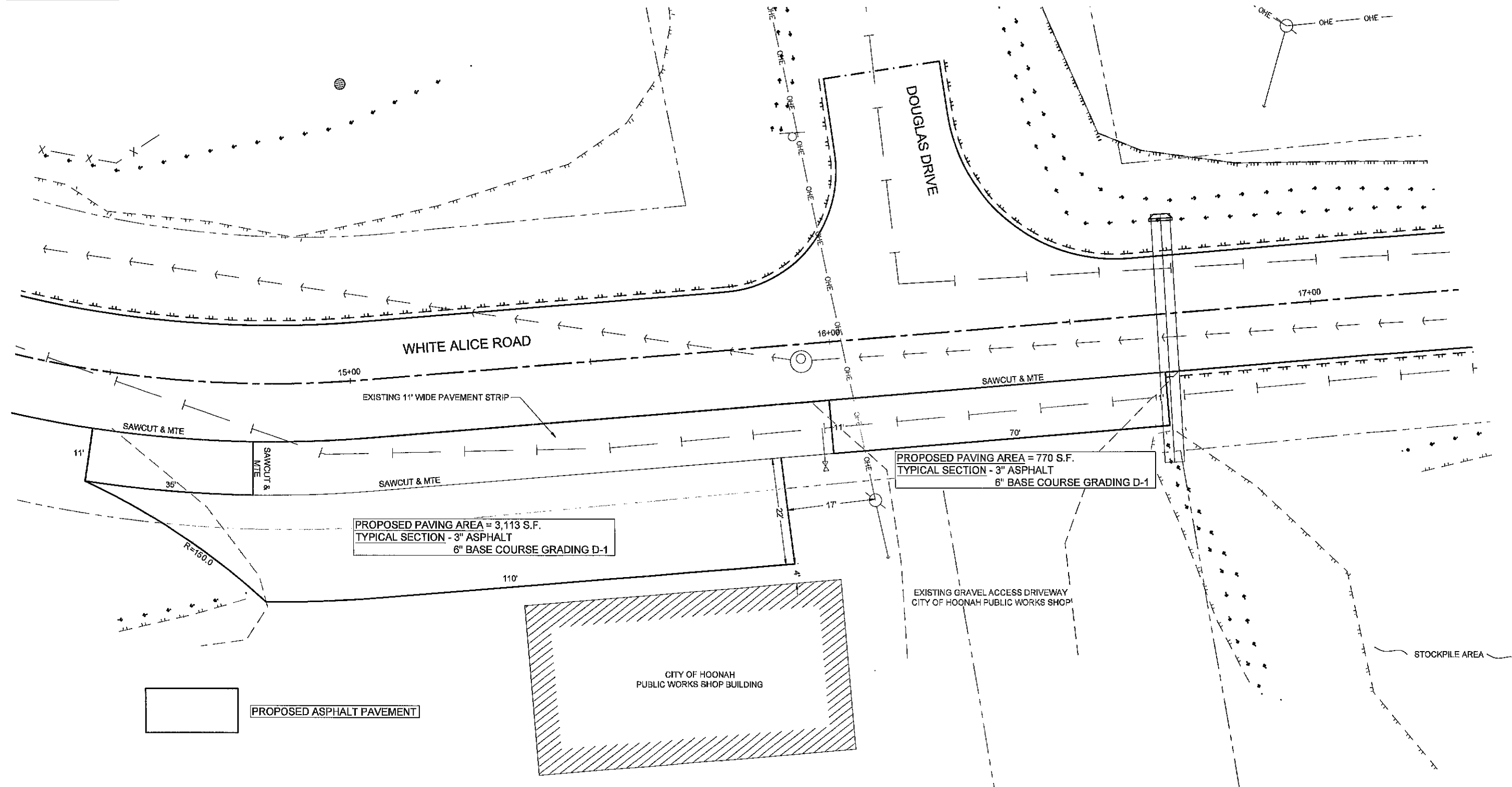

PROPOSED PAVING AREA = 3,113 S.F.
 TYPICAL SECTION - 3" ASPHALT
 6" BASE COURSE GRADING D-1

PROPOSED PAVING AREA = 770 S.F.
 TYPICAL SECTION - 3" ASPHALT
 6" BASE COURSE GRADING D-1

PROPOSED ASPHALT PAVEMENT

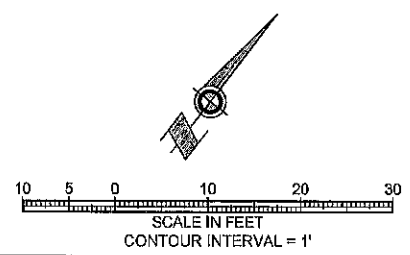

No.	Date	Item
REVISIONS		

SHEET TITLE:
**COH PUBLIC WORKS
 PAVING ADDITIONS**

CONSTRUCTION DOCUMENTS

PROJECT:
**CITY OF HOONAH FEMA FLOOD REPAIRS
 DECEMBER 2020 STORM EVENT 4585DR-AK**

HOONAH, ALASKA

RESPEC

Juneau, AK
 9109 Mendenhall Mall Rd. Ste. 4
 Juneau, AK 99801
 Phone: 907.780.6080
 Fax: 907.588.3771
 AECC163270

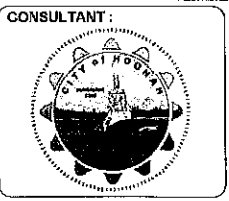
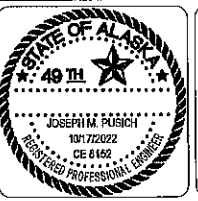

DESIGN	MSM
DRAWN	JMK
CHECKED	JMP
DATE	05/12/2023
PROJECT No.	10307.22002
SHEET NUMBER	

DIAL BEFORE YOU DIG!
 907-945-3355
 U/S POWER, TELEPHONE & TV.
 SHOWN ON THIS DRAWING INDICATE
 EXISTENCE ONLY AND DO NOT
 SUBSTITUTE FOR FIELD LOCATES

IF THIS BAR DOES NOT MEASURE EXACTLY ONE INCH, THE SCALE OF THIS DRAWING HAS BEEN ALTERED DURING ITS PRODUCTION, AFFECTING ALL LABELED SCALES

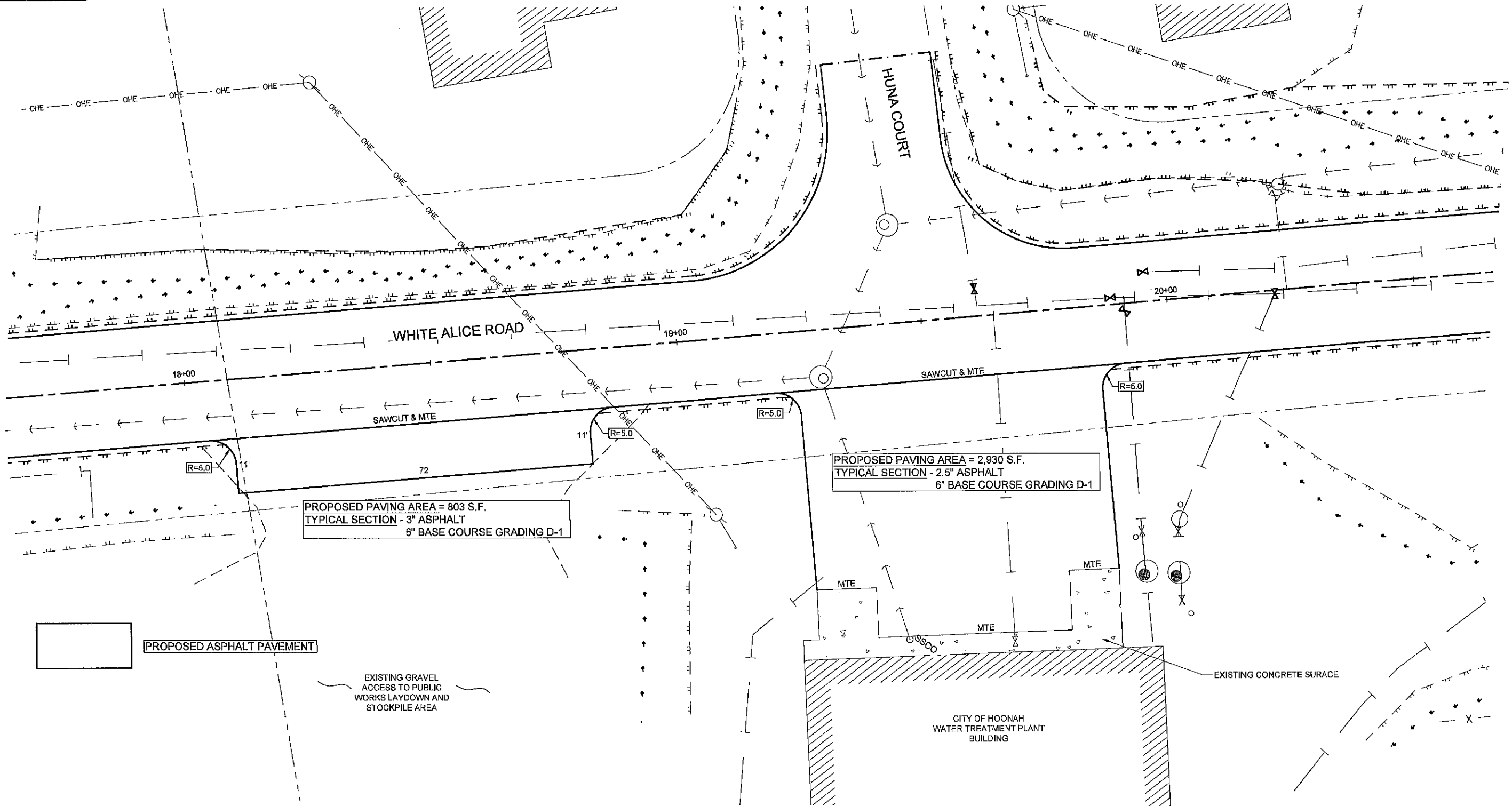

PROPOSED PAVING AREA = 803 S.F.
 TYPICAL SECTION - 3" ASPHALT
 6" BASE COURSE GRADING D-1

PROPOSED PAVING AREA = 2,930 S.F.
 TYPICAL SECTION - 2.5" ASPHALT
 6" BASE COURSE GRADING D-1

PROPOSED ASPHALT PAVEMENT

EXISTING GRAVEL
 ACCESS TO PUBLIC
 WORKS LAYDOWN AND
 STOCKPILE AREA

CITY OF HOONAH
 WATER TREATMENT PLANT
 BUILDING

EXISTING CONCRETE SURFACE

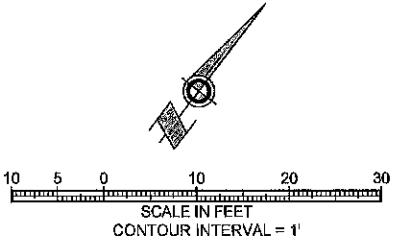

No.	Date	Item
REVISIONS		

SHEET TITLE:
**COH PUBLIC WORKS
 PAVING ADDITIONS**

CONSTRUCTION DOCUMENTS

PROJECT:
**CITY OF HOONAH FEMA FLOOD REPAIRS
 DECEMBER 2020 STORM EVENT 4585DR-AK**

HOONAH, ALASKA

RESPEC

Juneau, AK
 9109 Mendenhall Mall Rd. Ste. 4
 Juneau, AK 99801
 Phone: 907.780.6060
 Fax: 907.586.3771
 AECC163270



DESIGN	MSM
DRAWN	JMK
CHECKED	JMP
DATE	05/12/2023
PROJECT No. 10307.22002	
SHEET NUMBER	

IF THIS BAR DOES NOT MEASURE EXACTLY ONE INCH, THE SCALE OF THIS DRAWING HAS BEEN ALTERED DURING ITS PRODUCTION, AFFECTING ALL LABELED SCALES

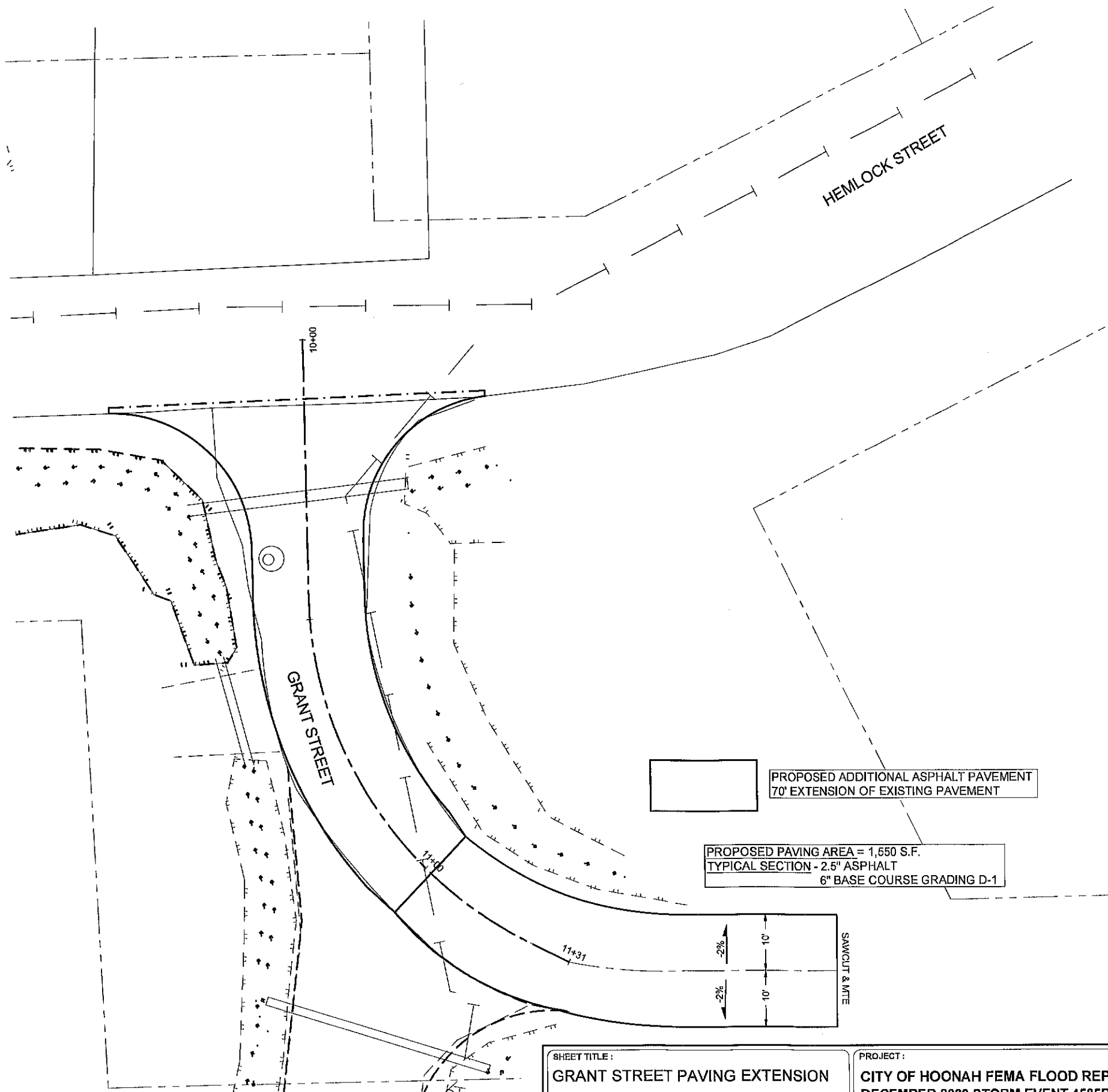

PROPOSED ADDITIONAL ASPHALT PAVEMENT
70' EXTENSION OF EXISTING PAVEMENT

PROPOSED PAVING AREA = 1,650 S.F.
TYPICAL SECTION - 2.5" ASPHALT
6" BASE COURSE GRADING D-1

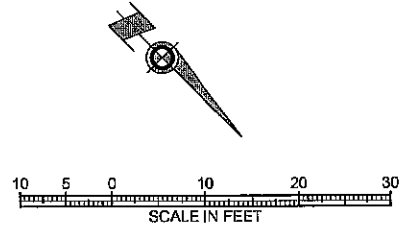
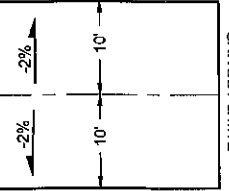

DIAL BEFORE YOU DIG!
907-945-3355
U/G POWER, TELEPHONE & T.V.
SHOWN ON THIS DRAWING INDICATE
EXISTENCE ONLY AND DO NOT
SUBSTITUTE FOR FIELD LOCATES

No.	Date	Item
REVISIONS		

SHEET TITLE:
GRANT STREET PAVING EXTENSION

CONSTRUCTION DOCUMENTS

PROJECT:
**CITY OF HOONAH FEMA FLOOD REPAIRS
DECEMBER 2020 STORM EVENT 4585DR-AK**

HOONAH, ALASKA

RESPEC

Juneau, AK
9109 Menzieshall Mall Rd. Sta. 4
Juneau, AK 99801
Phone: 907.780.6060
Fax: 907.566.3771
AECC163270

STATE OF ALASKA
49TH

JOSEPH M. PUSICH
10/17/2022
GE 8152
REGISTERED PROFESSIONAL ENGINEER

CONSULTANT:

DESIGN	MSH
DRAWN	JMK
CHECKED	JMP
DATE	05/12/2023
PROJECT No.	10307.22002
SHEET NUMBER	

IF THIS BAR DOES NOT MEASURE EXACTLY ONE INCH, THE SCALE OF THIS DRAWING HAS BEEN ALTERED DURING ITS PRODUCTION, AFFECTING ALL LABELED SCALES

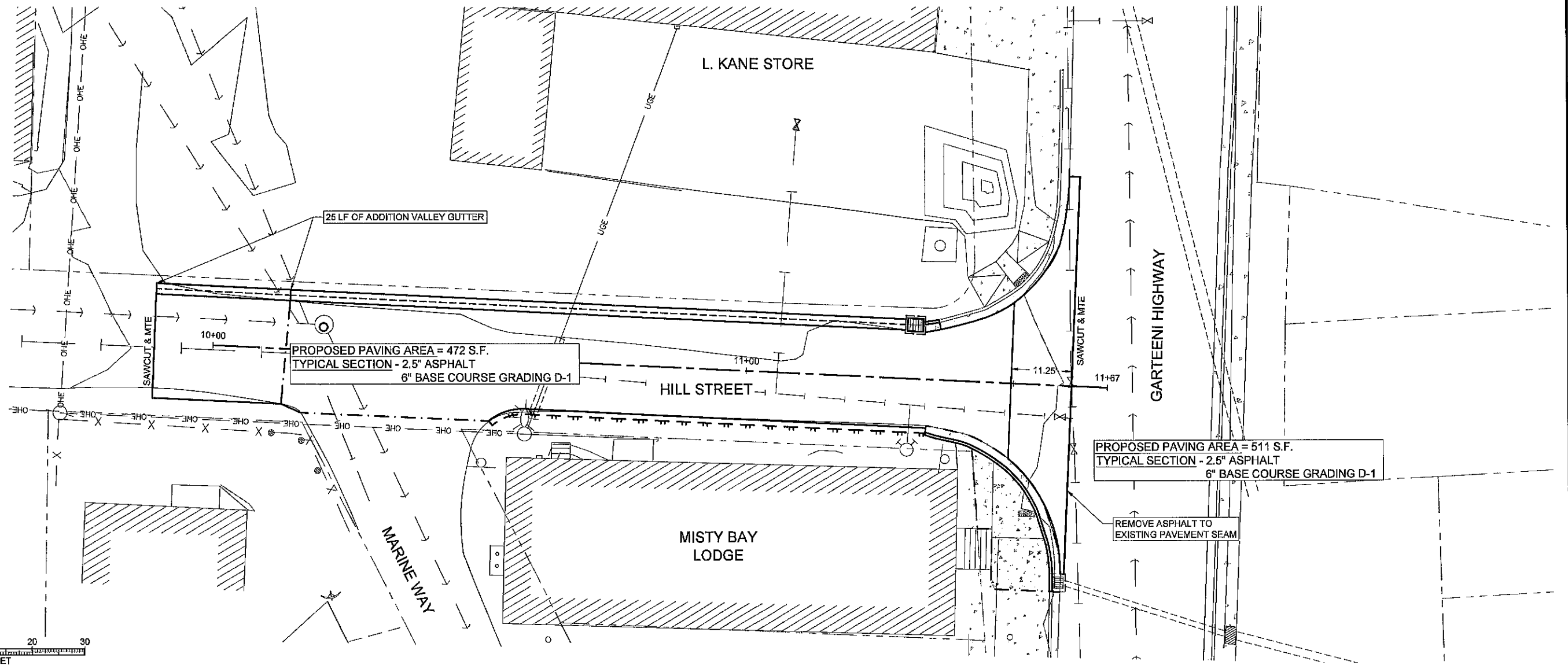

PROPOSED ASPHALT PAVEMENT

PROPOSED PAVING AREA = 511 S.F.
TYPICAL SECTION - 2.5" ASPHALT
6" BASE COURSE GRADING D-1

PROPOSED PAVING AREA = 472 S.F.
TYPICAL SECTION - 2.5" ASPHALT
6" BASE COURSE GRADING D-1

REMOVE ASPHALT TO EXISTING PAVEMENT SEAM

DIAL BEFORE YOU DIG!
907-945-3355
U/G POWER, TELEPHONE & T.V. SHOWN ON THIS DRAWING INDICATE EXISTENCE ONLY AND DO NOT SUBSTITUTE FOR FIELD LOCATES

K:\Projects\10307-22002-COUL_FEMA\Final\Drawings\AreaPaving\AreaPaving.dwg 10/07/2022 11:54:16 AM May 12, 2022 1:54:16 PM

No.	Date	Item
REVISIONS		

SHEET TITLE:
HILL STREET PAVING ADDITIONS

CONSTRUCTION DOCUMENTS

PROJECT:
**CITY OF HOONAH FEMA FLOOD REPAIRS
DECEMBER 2020 STORM EVENT 4585DR-AK**

HOONAH, ALASKA

RESPEC

Juneau, AK
9109 Mendonhall Mall Rd. Ste. 4
Juneau, AK 99901
Phone: 907.780.6050
Fax: 907.686.3771
AECC163270

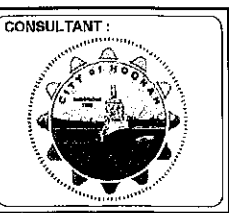
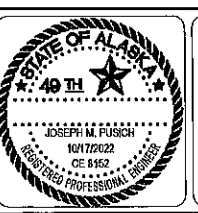

DESIGN	MSSM
DRAWN	JMK
CHECKED	JMP
DATE	05/12/2022
PROJECT No.	10307.22002
SHEET NUMBER	